



# FLV

## Screw-on flat face couplings, robust and compact design. Market interchange.

This series combines the advantages of flat face screw coupling technology with an extremely compact and robust design. Ideal for applications in which a flat face connection is required and there are no significant residual pressures to manage. The Zinc-Nickel plating guarantees a remarkable resistance to corrosion. Female couplers body allows panel installation.



## Applications



## Pressure Drop

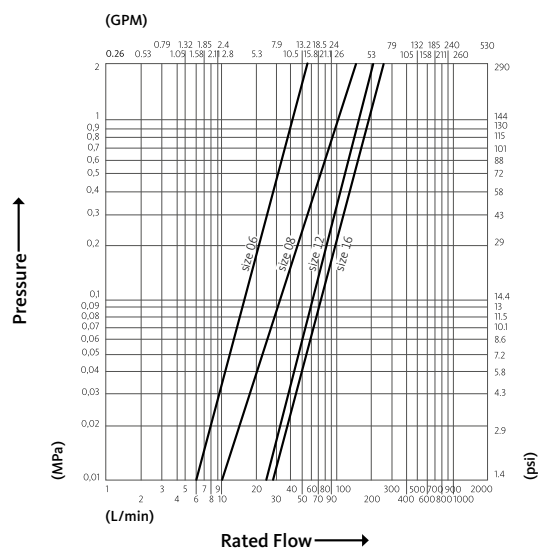

Test performed according to ISO 18869

## Technical Specifications

dash	Size mm	inch	Working Pressure (MPa)	Flow Rate (l/min)	Spillage (ml)	Force to Connect (N)	Burst pressure (MPa)		
							Male	Female	Male + Female
06	10	3/8"	42	32	0.02	130	140	250	
08	12.5	1/2"	42	75	0.02	130	100	155	
12	20	3/4"	42	120	0.06	110	130	130	
16	25	1"	42	165	0.1	125	170	160	

Material	<b>Steel</b>
Seals	<b>NBR</b>
Working temperatures	<b>- 25 °C to + 100 °C</b>
Surface treatment	<b>MATE 1000 (ZnNi)</b>
Series Interchange	<b>MARKET</b>

Valve Type	<b>Flat</b>
Connection	<b>Screw to Connect</b>
Disconnection	<b>Unscrew to Disconnect</b>
Connection Under Pressure	<b>Not Allowed</b>

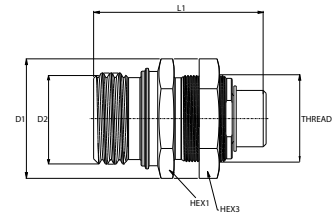

**FLV**

Size		Thread details			FEMALE									
mm	inch	Thread Type	Standard	Thread	Part Number	L (L1 + Thread)		D1		D2 (Connection Thread)	HEX1		HEX3	
						mm	inch	mm	inch		mm	inch	mm	inch
10	3/8'	03/ METRIC	ISO 8434-1-S	M24x1,5 Male	FLV06-3/2415 F	67	2,64	46	1,81	M32x3	41	1,61	22	0,87
10	3/8'	03/ METRIC	ISO 8434-1-S	M22x1.5 MALE 14S	FLV06-3/2215 F	84	3,31	68	2,68	M32x3	60	2,36	32	1,26
10	3/8'	06/ METRIC	ISO 8434-1-S	M20x1.5 MALE BULKHEAD 12S	FLV06-3/2015 F	77,4	3,05	54	2,13	M32x3	46	1,81	24	0,94
10	3/8'	03/ METRIC	ISO 8434-1-S	M18x1.5 MALE 10S	FLV06-3/1815 F	75,4	2,97	52	2,05	M32x3	46	1,81	24	0,94
10	3/8'	02/ METRIC	ISO 8434-1-L	M22x1,5 MALE 15L	FLV06-2/2215 F	67	2,64	46	1,81	M32x3	41	1,61	22	0,87
10	3/8'	02/ METRIC	ISO 8434-1-L	M16x1,5 MALE 12L	FLV06-2/1615 F	65	2,56	46	1,81	M32x3	41	1,61	22	0,87
10	3/8'	02/ METRIC	ISO 8434-1-L	M18x1,5 MALE 12L	FLV06-2/1815 F	65	2,56	46	1,81	M32x3	41	1,61	22	0,87
20	3/4'	02/ METRIC	ISO 8434-1-L	M26x1,5 MALE 18L	FLV12-2/2615 F	103	4,06	62	2,44	M48x3	55	2,17	60	2,36
20	3/4'	03/ METRIC	ISO 8434-1-S	M30x2 MALE 20S	FLV12-3/3020 F	98	3,86	62	2,44	M48x3	55	2,17	60	2,36
25	1'	03/ METRIC	ISO 8434-1-S	M36x2 MALE 25S	FLV16-3/3620 F	62,2	2,45	42	1,65	M54x4	36	1,42	36	1,42
25	1'	03/ METRIC	ISO 8434-1-S	M30x2 MALE 20S	FLV16-3/3020 F	62,2	2,45	42	1,65	M54x4	36	1,42	36	1,42
25	1'	02/ METRIC	ISO 8434-1-L	M36x2 MALE 28L	FLV16-2/3620 F	60,2	2,37	42	1,65	M54x4	36	1,42	36	1,42
25	1'	02/ METRIC	ISO 8434-1-L	M30x2 MALE 22L	FLV16-2/3020 F	60,2	2,37	42	1,65	M54x4	36	1,42	36	1,42
25	1'	02/ METRIC	ISO 8434-1-L	M26x1,5 MALE 18L	FLV16-2/2615 F	59,2	2,33	42	1,65	M54x4	36	1,42	36	1,42
12,5	1/2'	03/ METRIC	ISO 8434-1-S	M30x2 MALE 20S	FLV08-3/3020 F	88	3,46	68	2,68	M36x3	60	2,36	32	1,26
12,5	1/2'	03/ METRIC	ISO 8434-1-S	M24x1,5 Male	FLV08-3/2415 F	85	3,35	61	2,4	M36x3	55	2,17	50	1,97
12,5	1/2'	02/ METRIC	ISO 8434-1-L	M22x1,5 MALE 15L	FLV08-2/2215 F	70	2,76	47	1,85	M36x3	41	1,61	41	1,61
31,5	1-1/4'	03/ METRIC	ISO 8434-1-S	M52x2 MALE 38S	FLV20-3/5220 F	64	2,52	46	1,81	M79x4	41	1,61	22	0,87
31,5	1-1/4'	02/ METRIC	ISO 8434-1-L	M45x2 MALE 35L	FLV20-2/4520 F	59,2	2,33	42	1,65	M79x4	36	1,42	36	1,42

**FLV**

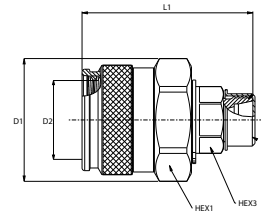

Size		Thread details			MALE										
mm	inch	Thread Type	Standard	Thread	Part Number	L (L1 + Thread)		D1		D2 (Connection Thread)		HEX1		HEX3	
						mm	inch	mm	inch	mm	inch	mm	inch	mm	inch
10	3/8'	03/ METRIC	ISO 8434-1-S	M22x1.5 MALE 14S	FLV06-3/2215 M	136	5,35	90	3,54	M32x3		80	3,15	55	2,17
10	3/8'	03/ METRIC	ISO 8434-1-S	M24x1,5 Male	FLV06-3/2415 M	136	5,35	90	3,54	M32x3		80	3,15	55	2,17
10	3/8'	03/ METRIC	ISO 8434-1-S	M20x1,5 Male	FLV06-3/2015 M	113	4,45	65	2,56	M32x3		55	2,17	41	1,61
10	3/8'	03/ METRIC	ISO 8434-1-S	M18x1.5 MALE 10S	FLV06-3/1815 M	111	4,37	65	2,56	M32x3		55	2,17	41	1,61
10	3/8'	02/ METRIC	ISO 8434-1-L	M22x1,5 MALE 15L	FLV06-2/2215 M	109	4,29	65	2,56	M32x3		55	2,17	41	1,61
10	3/8'	02/ METRIC	ISO 8434-1-L	M16x1,5 MALE 12L	FLV06-2/1615 M	109	4,29	65	2,56	M32x3		55	2,17	41	1,61
10	3/8'	02/ METRIC	ISO 8434-1-L	M18x1,5 MALE 12L	FLV06-2/1815 M	65	2,56	46	1,81	M32x3		41	1,61	22	0,87
20	3/4'	02/ METRIC	ISO 8434-1-L	M26x1,5 MALE 18L	FLV12-2/2615 M	64	2,52	46	1,81	M48x3		41	1,61	22	0,87
20	3/4'	03/ METRIC	ISO 8434-1-S	M30x2 MALE 20S	FLV12-3/3020 M	101	3,98	62	2,44	M48x3		55	2,17	60	2,36
25	1'	03/ METRIC	ISO 8434-1-S	M36x2 MALE 25S	FLV16-3/3620 M	98	3,86	62	2,44	M54X4		55	2,17	60	2,36
25	1'	03/ METRIC	ISO 8434-1-S	M30x2 MALE 20S	FLV16-3/3020 M	81	3,19	61	2,4	M54X4		55	2,17	50	1,97
25	1'	02/ METRIC	ISO 8434-1-L	M36x2 MALE 28L	FLV16-2/3620 M	74,5	2,93	47	1,85	M54X4		41	1,61	41	1,61
25	1'	02/ METRIC	ISO 8434-1-L	M30x2 MALE 22L	FLV16-2/3020 M	72	2,83	47	1,85	M54X4		41	1,61	41	1,61
25	1'	02/ METRIC	ISO 8434-1-L	M26x1,5 MALE 18L	FLV16-2/2615 M	60,2	2,37	42	1,65	M54X4		36	1,42	36	1,42
12,5	1/2'	03/ METRIC	ISO 8434-1-S	M30x2 MALE 20S	FLV08-3/3020 M	132	5,2	89,8	3,54	M36X3		85	3,35	24	0,94
12,5	1/2'	03/ METRIC	ISO 8434-1-S	M24x1,5 Male	FLV08-3/2415 M	129	5,08	89,8	3,54	M36X3		85	3,35	55	2,17
12,5	1/2'	02/ METRIC	ISO 8434-1-L	M22x1,5 MALE 15L	FLV08-2/2215 M	73,4	2,89	52	2,05	M36X3		46	1,81	24	0,94
31,5	1-1/4'	03/ METRIC	ISO 8434-1-S	M52x2 MALE 38S	FLV20-3/5220 M	107	4,21	65	2,56	M79X4		55	2,17	41	1,61
31,5	1-1/4'	02/ METRIC	ISO 8434-1-L	M45x2 MALE 35L	FLV20-2/4520 M	96	3,78	70	2,76	M79X4		60	2,36	46	1,81