

## PB RK Tube-coupling



Argus Tube-coupling enables a leakage-free connection or disconnection of loaded pipes.

The coupling consists of a fixed and a loose part. The coupling of both parts is done by hand nut i.e. handwheel up to the limit stop. Valves are opening in both parts against spring power.

When uncoupling the valves are closing before the coupling parts are disconnected. Therefore no air can enter into the pipes.

### Construction specifications

- very robust construction
- sealing elements individually changeable
- no medium loss during coupling, no pollution
- ventilation afterwards is not necessary

Under pressure the coupling can be done manually up to 20 bar. With tools coupling and uncoupling under higher pressure is possible.

When disconnected, both coupling parts are protected against pollution and damage by using the corresponding accessories.

### Case, inner parts and screwed sockets

Case and inner parts are zinc coated, valve tube in the loose part is brass, all sealings are NBR (sealing FPM possible). Through additional passivation all zinc coatings have an improved surface protection.

### Usability

for fluid pipes with pressure liquids on mineral oil basis according to DIN 51524 T1&T2. On request also for hardly inflammable pressure liquids according VDMA 24317. For pneumatic and water hydraulic available in corresponding materials.

### Temperature

between -40°C and 100°C (for sealings FPM up to 200°C).

# PB RK Tube-coupling



## fixed part F

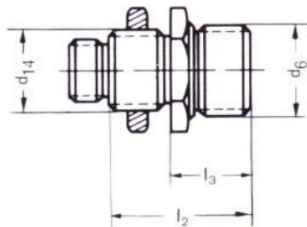

DN	PN bar ge- kuppelt	PN bar ent- kuppelt	d6	d14	l2 mm	l3 mm
6	315	250	Rd 32x3	M30 x 1,0	44	24
8	315	250	Rd 32x3	M30 x 1,0	44	24
10	315	250	Rd 32x3	M30 x 1,0	44	24
12	315	250	Rd 48x3	M45 x 1,5	63	35
16	315	250	Rd 48x3	M45 x 1,5	63	35
20	160	160	Rd 60x3	M56 x 1,5	60	34
25	160	160	Rd 60x3	M56 x 1,5	60	34

## loose part L

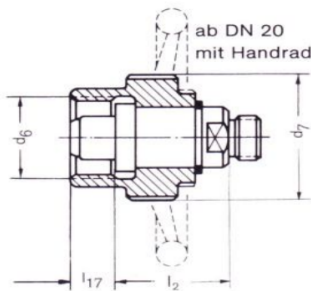

DN	PN bar ge- kuppelt	PN bar ent- kuppelt	d6	d7 mm	l2 mm	l17* mm
6	315	200	Rd 32x3	40	37 ± 2	14
8	315	200	Rd 32x3	40	37 ± 2	14
10	315	200	Rd 32x3	40	37 ± 2	14
12	315	315	Rd 48x3	60	43	24
16	315	315	Rd 48x3	60	43	24
20	160	100	Rd 60x3	154	41	28
25	160	100	Rd 60x3	154	41	28

necessary space for coupling\*

## flow resistance of tube-coupling

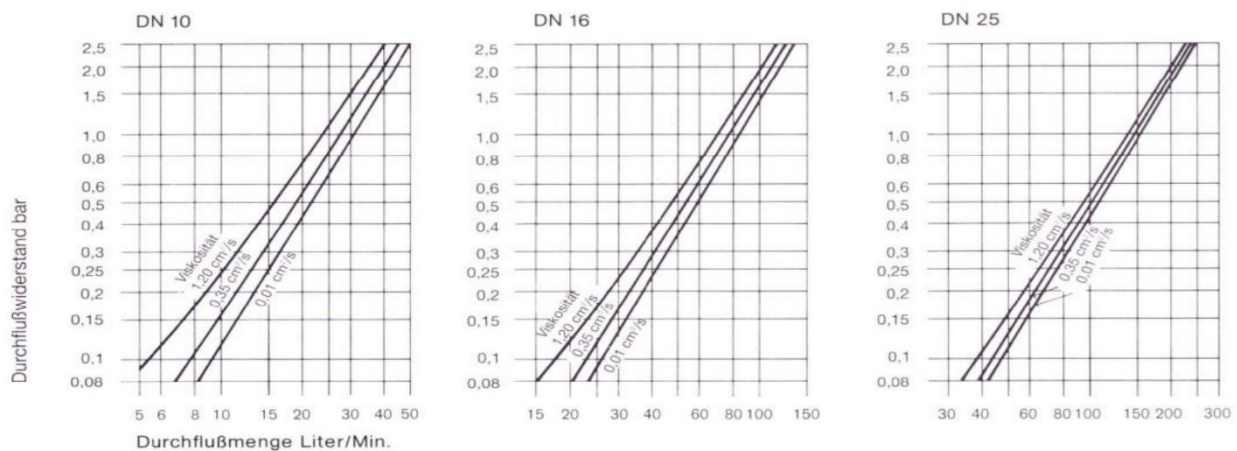

average of both flow directions

# PB RK Tube-coupling

Anschlussarten	DN	RA mm	d1	l8 mm	t2 mm	Festhälfte ohne Sechskantmutter		Festhälfte mit Sechskantmutter		Loshälfte	
						Gewicht in kg	Bestell- nummer	Gewicht in kg	Bestell- nummer	Gewicht in kg	Bestell- nummer
<b>D1</b> Stutzen 24° DIN 3902, leichte Reihe.	6	8	M14x1,5	10	7,0	0,190	340831	0,210	340838	0,300	340845
	8	10	M16x1,5	11	7,0	0,190	340832	0,210	340839	0,300	340846
	10	12	M18x1,5	11	7,0	0,190	340833	0,210	340840	0,300	340847
	12	15	M22x1,5	12	7,0	0,570	340834	0,650	340841	0,875	340848
	16	18	M26x1,5	12	7,5	0,570	340835	0,650	340842	0,875	340849
	20	22	M30x2,0	14	7,5	0,665	340836	0,800	340843	1,850	340850
	25	28	M36x2,0	14	7,5	0,665	340837	0,800	340844	1,850	340851
<b>E1</b> Stutzen 24° DIN 3902, schwere Reihe.	6	10	M18x1,5	12	7,5	0,200	340852	0,220	340859	0,305	340866
	8	12	M20x1,5	12	7,5	0,200	340853	0,220	340860	0,305	340867
	10	14	M22x1,5	14	8,0	0,200	340854	0,220	340861	0,305	340868
	12	16	M24x1,5	14	8,5	0,590	340855	0,670	340862	0,895	340869
	16	20	M30x2,0	16	10,5	0,590	340856	0,670	340863	0,895	340870
	20	25	M36x2,0	18	12,0	0,705	340857	0,850	340864	1,925	340871
	25	30	M42x2,0	20	13,5	0,730	340858	0,870	340865	2,050	340872

## mounting arrangements

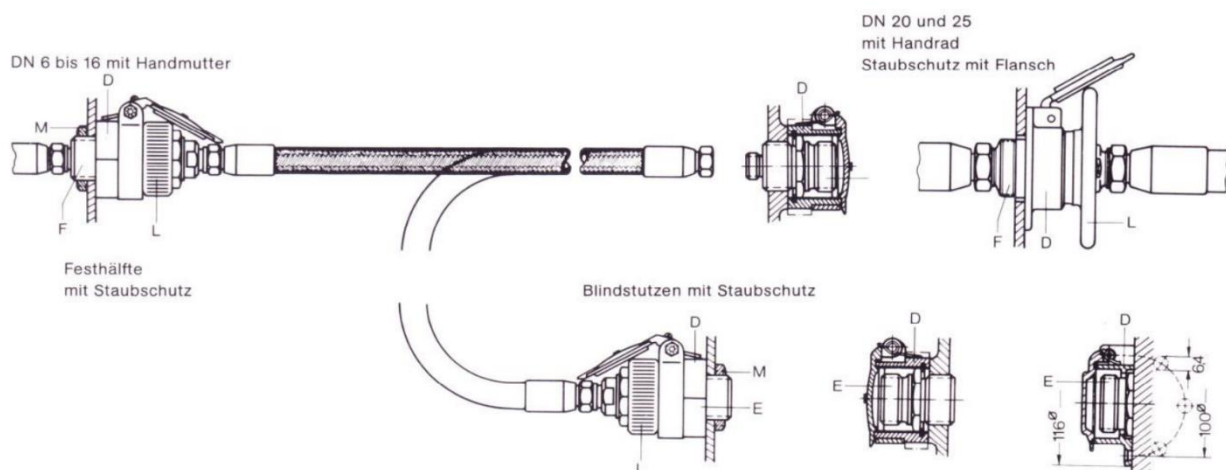

# PB RK Tube-coupling



## dust guard D

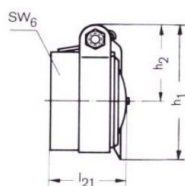

DN	h1 mm	h2 mm	l21 mm	SW6 mm	Gewicht in kg weight	Bestell- nummer order-no.
6	68,0	38	35	46	0,040	340800
8	68,0	38	35	46	0,040	340800
10	68,0	38	35	46	0,040	340800
12	95,5	52	50	70	0,220	340801
16	95,5	52	50	70	0,220	340801
20*	107,0	58	47		0,850	340802
25*	107,0	58	47		0,850	340802

\*dust guard with flange

## blind muff E

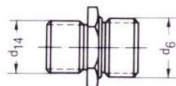

DN	d6	d14	Gewicht in kg weight	Bestell- nummer order-no.
6	Rd 32 x 3	M30 x 1,0	0,140	340803
8	Rd 32 x 3	M30 x 1,0	0,140	340803
10	Rd 32 x 3	M30 x 1,0	0,140	340803
12	Rd 48 x 3	M45 x 1,5	0,380	340804
16	Rd 48 x 3	M45 x 1,5	0,380	340804
20*	Rd 60 x 3		0,180	340805
25*	Rd 60 x 3		0,180	340805

\*without threaded stem

## hexagon nut M - for fixed part and blind muff

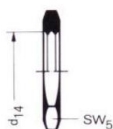

DN	d14	Gewicht in kg weight	Bestell- nummer order-no.
6	M30 x 1,0	0,020	340806
8	M30 x 1,0	0,020	340806
10	M30 x 1,0	0,020	340806
12	M45 x 1,5	0,040	340807
16	M45 x 1,5	0,040	340807
20	M56 x 1,5	0,060	340808
25	M56 x 1,5	0,060	340808