

1 OIL CAP FLANGE

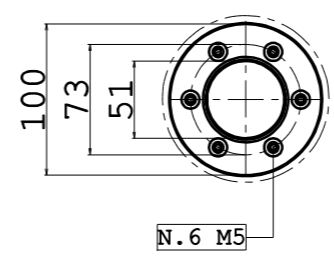

2 RETURN FILTER FLANGE

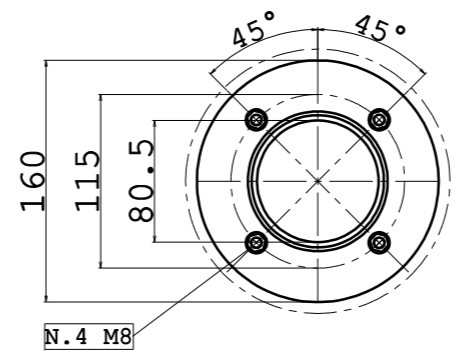

7 RETURN VALVE PLATE

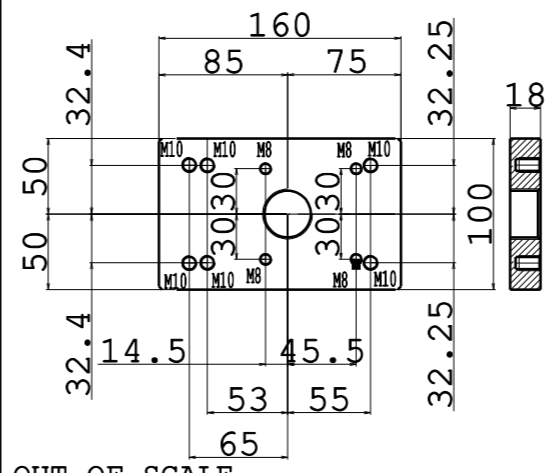

4 1"1/2 SUCTION ADAPTER

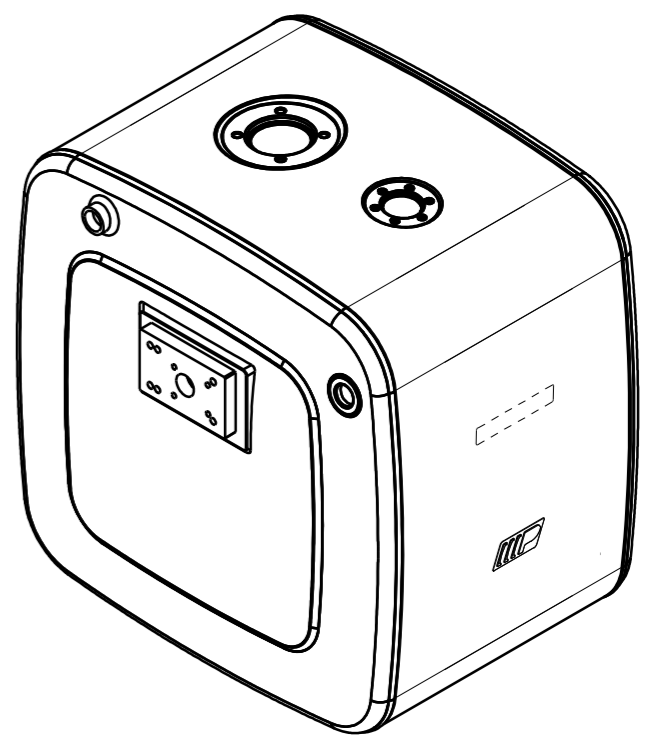
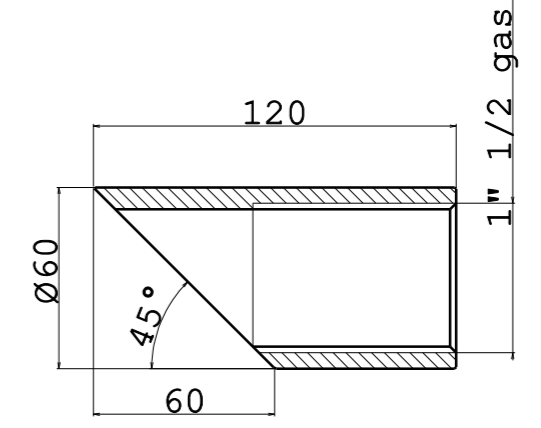

Tank composition

Pos.	Denomination	Q.ty
1	OIL CAP FLANGE	1
2	RETURN FILTER FLANGE	1
3	1" LEVEL INDICATOR	1
4	1" 1/2 SUCTION CONNECTION	1
5	1" REAR RETURN CONNECTION	1
6	1" RETURN CONNECTION	1
7	RETURN VALVE PLATE	1

Tank dimensions

Level indicator capacity	203 Lt
Full capacity	240 Lt
Support weight	27 Kg
Tank weight (F,I,T)	kg (A) kg
Dimension	550x700x700 mm

0	EMISSION	03/08/2016	FM	MM	EB
Rev.	Description	Date	Dis.	Ver.	App.
	Part name : Oil tank 250 LT Al/Steel/St.Steel fam. 700x700				
	Part code : NSOX0250055MFPG				
	Scale 1:10				
	Replace the				
	Replaced by				
	Material code				
	(X)=F:Steel DC03A EN 10130				
	(X)=I:Stainless steel AISI 304 UNI EN 10088				
	(X)=T:Textured stainless steel. AISI 304 UNI EN 10088				
	(X)=A:Aluminium EN AW 5754				
	OWNERSHIP OF THIS DRAWING IS RESERVED BY LAW AND MAY NOT BE REPRODUCED IN WHOLE OR IN PART WITHOUT PERMISSION OF PADOAN S.R.L.				
	General tolerances: ISO 2768 V				
	Drawing format A3				
	DO NOT MAKE MEASUREMENTS ON DRAWING DO NOT CHANGE WITHOUT TECHNICAL OFFICE AUTHORIZATION				

