

1 OIL CAP FLANGE

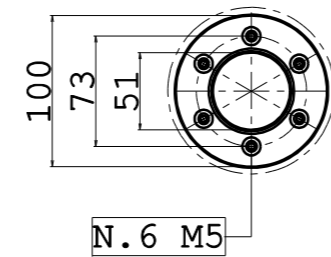

SCALE 1:5

2 RETURN FILTER FLANGE

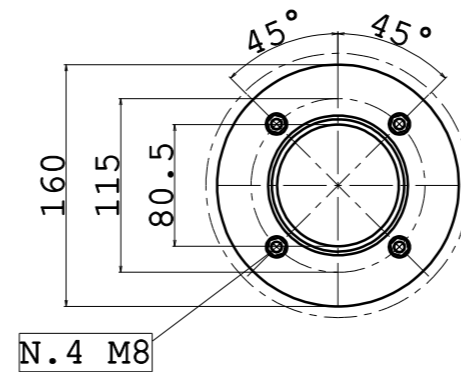

SCALE 1:5

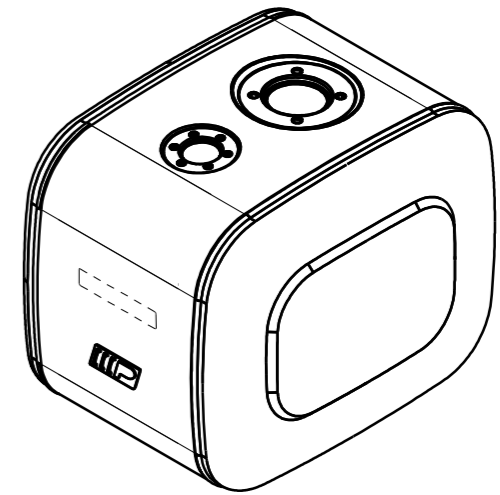

Tank composition

| Pos. | Denomination | Q.ty |
|------|-------------------------------|------|
| 1 | OIL CAP FLANGE | 1 |
| 2 | RETURN FILTER FLANGE | 1 |
| 3 | 1" LEVEL INDICATOR | 1 |
| 4 | OIL RETURN CONNECTION 1" | 1 |
| 5 | OIL SUCTION CONNECTION 1" 1/4 | 1 |
| | | |
| | | |
| | | |
| | | |

Tank dimension

| | |
|--------------------------|----------------|
| Level indicator capacity | 60 Lt |
| Full capacity | 80 Lt |
| Support weight | 16 Kg |
| Tank weight (F,I,T) | kg (A) kg |
| Dimensions | 400x440x540 mm |

| Rev. | Modify description | Date | Des. | Ver. | App. |
|------|--|------------|------|------|------|
| 1 | RETURN CONNECTION POS.4 FROM 130 TO 135 mm | 10/03/2017 | MM | MM | EB |
| 0 | EMISSION | 05/12/2016 | MM | MM | EB |

| | | | |
|-------------|---|-------------|--|
| Part name : | Oil tank 80 LT Al/Steel/Stainl.Steel fam. 440x540 | | |
| Part code : | NSO (X) 0080040MF00 | Replace the | Material code |
| Scale | 1:10 | Replaced by | (X)=F:Steel DC03A EN 10130 |
| | | | (X)=I:Stainless Steel AISI 304 UNI EN 10088 |
| | | | (X)=T:Text Stainless Steel AISI 304 UNI EN 10088 |
| | | | (X)=A:Alluminium EN AW 5754 |

| | |
|--|--|
| General tolerances: ISO 2768 V | |
| Drawing format A3 | |
| OWNERSHIP OF THIS DRAWING IS RESERVED BY LAW AND MAY NOT BE REPRODUCED IN WHOLE OR IN PART WITHOUT PERMISSION OF PADOAN S.R.L. | |
| DO NOT MAKE MEASUREMENTS ON DRAWING DO NOT CHANGE WITHOUT TECHNICAL OFFICE AUTHORIZATION | |

