

EV SLPD 20/20, 28/28 DIN SAVTEC

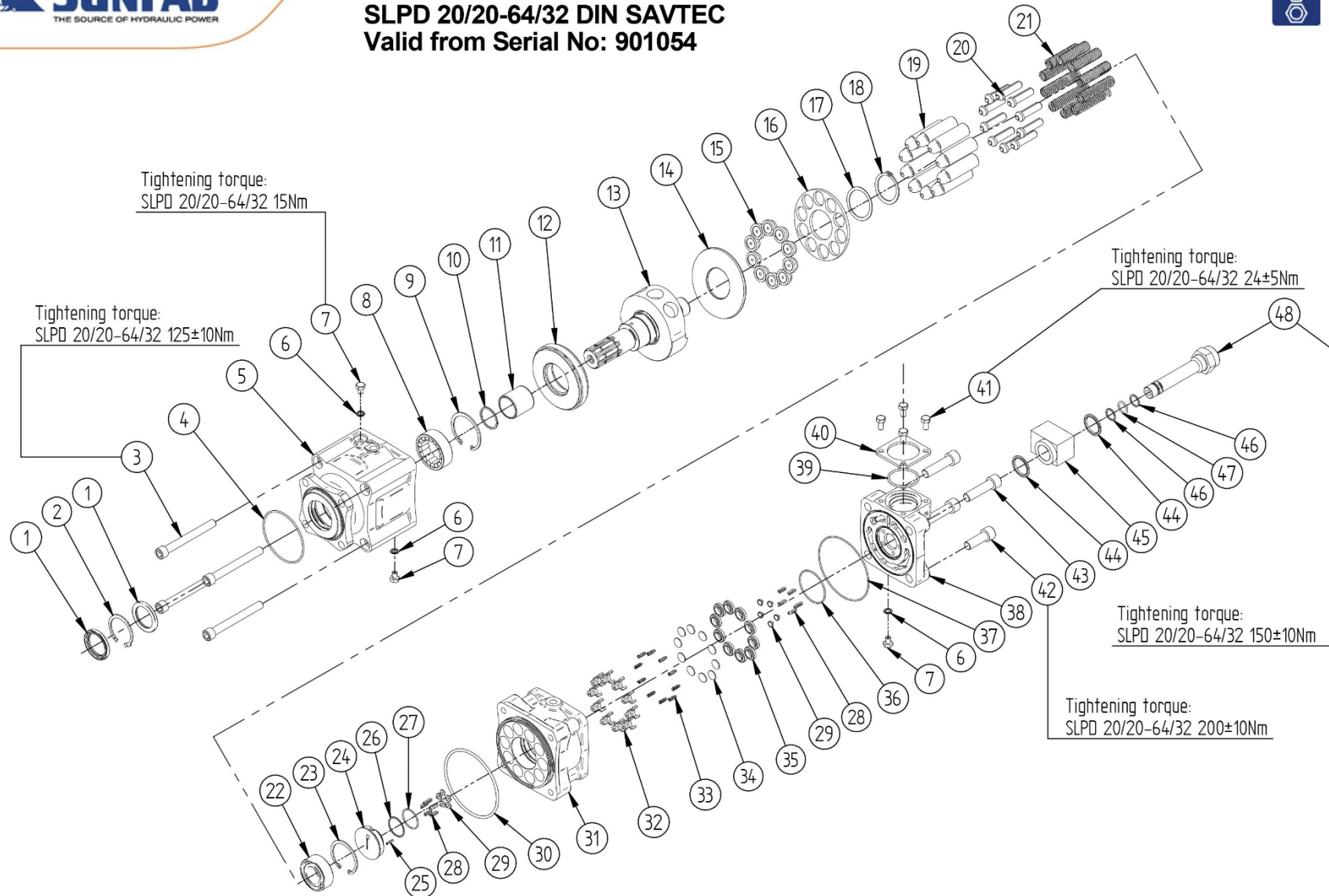

SLPD 20/20-64/32 DIN SAVTEC Valid from Serial No: 901054



EV SLPD 20/20, 28/28 DIN SAVTEC



SLPD 20/20, 28/28 DIN SAVTEC

Item	Title	Type*	Qty.
1	Shaft seal N	N - NBR	2
	Shaft seal V	V - Viton	
2	Lock ring		1
3	Bolt		4
4	O-ring		1
5	Bearing housing	DL4 DIN 4-Hole	1
6	Seal washer		3
7	Bleed screw		3
8	Roller bearing		1
9	Lock ring		1
10	Lock ring		1
11	Innerring		1
12	Thrust bearing		1
13	Shaft SLPD 20/20	L35 - 20/20	1
	Shaft SLPD 28/28	L35 - 28/28	
14	Axial plate		1
15	Sliding pad		6
16	Sliding pad holder		1
17	Spacer ring		1
18	Lock ring		1
19	Piston		6
20	Filling pin		6
21	Spring		6
22	Roller bearing		1
23	Lock ring		1
24	Valve holder		1
25	Lock pin		1
26	Support ring		1
27	O-ring		1
28	Spring		9
29	Pressure valve disc		9
30	O-ring		1
31	Cylinder block		1
32	Suction valve guide		6
33	Spring		6
34	Suction valve disc		6
35	Suction valve seat		6
36	O-ring		1
37	O-ring		1
38	Back cover	S4S-4	1
39	O-ring		1
40	Clamping plate		2
41	Bolt		4
42	Bolt		1
43	Bolt		3
44	Seal washer		2
45	T-connection		1
46	Support ring		2
47	O-ring		1
48	Banjo bolt		1

Spare part kits SLPD 20/20-64/32 DIN

Included Items	Title
1, 2, 4, 6, 26, 27, 30, 36, 37, 39, 43, 45, 46	Seal kit
28, 29, 32, 33, 34, 35	Valve kit
43, 45, 46, 47	Banjo bolt kit
10, 11, 13	Shaft kit 20/20, 40/20, 35/35
10, 11, 13	Shaft kit 28/28, 56/28, 46/46
10, 11, 13	Shaft kit 53/53, 64/32
24, 25, 26, 27	Valve holder kit 35/35, 46/46, 53/53
24, 25, 26, 27	Valve holder kit 40/20, 56/28, 64/32
6, 7	Bleed screw kit
39, 40, 41	Clamping plate kit



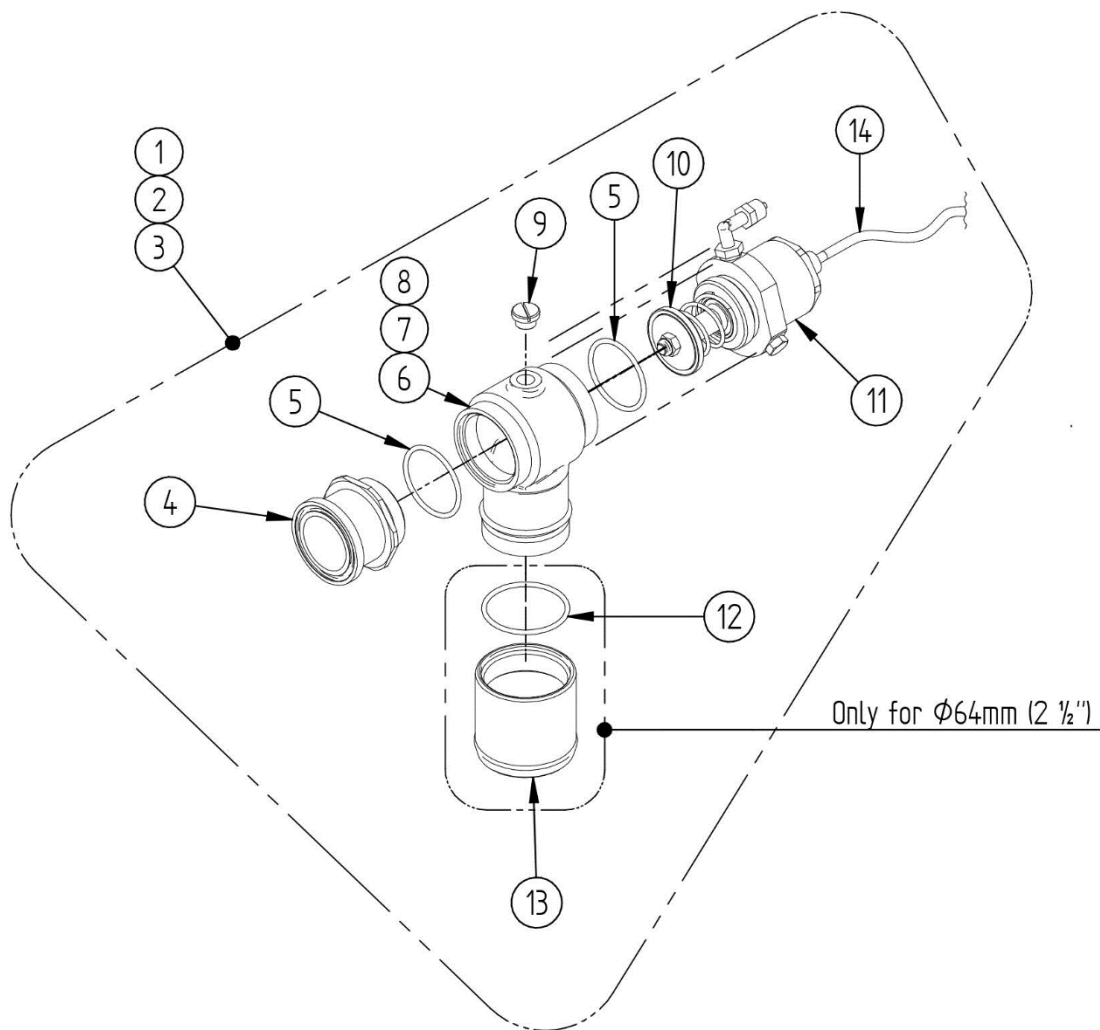

SAVTEC Valve pneumatic

Item	Title	Type*	Qty.
1	Savtec valve complete	Ø38mm (1 1/2")	
2	Savtec valve complete	Ø50mm (2")	
3	Savtec valve complete	Ø64mm (2 1/2")	
4	Valve seat		1
5	O-ring		2
6	Valve housing	Ø38mm (1 1/2")	1
7	Valve housing	Ø50mm (2")	1
8	Valve housing	Ø64mm (2 1/2")	1
9	Plug plastic		1
10	Valve washer		1
11	Cylinder		1
12	O-ring	Ø64mm (2 1/2")	1
13	Connection	Ø64mm (2 1/2")	1
14	Hose PA	Ø6x1mm L=4m	1